

---

# LG INVERTER HEATPUMP WATER HEATER



# LG INVERTER HEAT PUMP WATER HEATER

## What is LG Inverter Technology?

LG Inverter Technology is applied to various electronics including refrigerators and washing machines, especially to air conditioners which continuously receive global attention. With Inverter technology, consumer may have better energy saving and more saving money on their utility bills

### Power Consumption Change

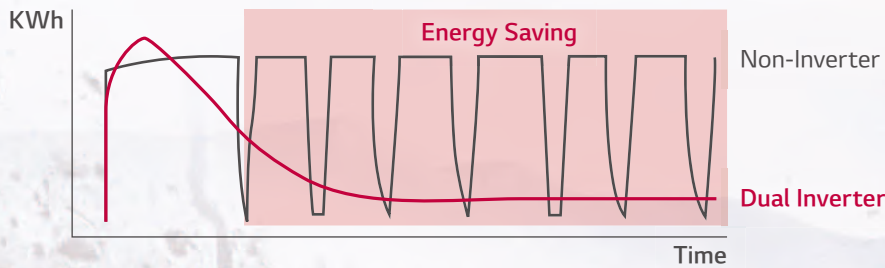

## What is LG Inverter Heat Pump Water Heater ?

### Modernized Technology : Replacing Conventional Type Heater

In recent years, interest in these environmentally friendly devices has been increasing because global warming and environment pollution has been progressing fast. and in order to meet these market demands, LG has further developed their heat pump technology to produce the most efficient, environmentally friendly products in the industry.

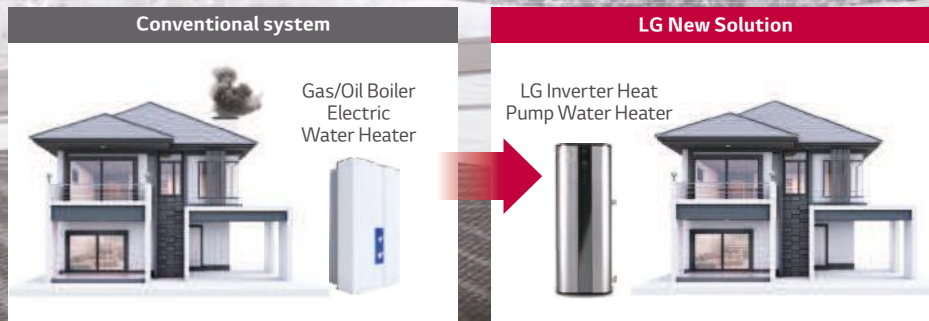

## VARIOUS INSTALLATION PLACE



Laundry Room



Storage Room



Bathroom

\* Actual product appearance may differ from the above simulated scene.



Bathroom



Garage



Garage

# FOR USER

## INVERTER TECHNOLOGY



### Highest Energy Efficiency

LG's heat pump water heater using market first DUAL Inverter Compressor achieved COP 3.45 (270L) and COP 3.3 (200L), the highest efficiency in the industry. Save up to 80% more energy than Electric Water Heater (250L, A Class)

1) Simulation Data on Daily Electricity Consumption, based on EU Climate Condition (Average)

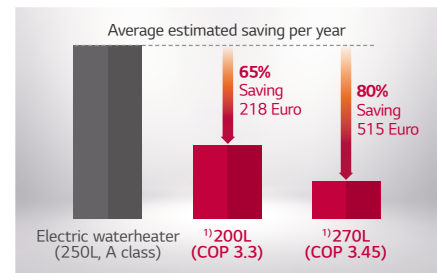

### Fast & Powerful Water Heating

The DUAL Inverter Compressor allows the maximization of the power of heat pump. And it can heat up to 20% faster and 30% warmer at Turbo Mode than Non-Inverter water heater.

\* Dual Inverter Max Hz plus Heater Logic Optimization



### Low noise 46dBA

Through BLDC Motor and DUAL Inverter Compressor, noise is reduced to 46dBA and provides a comfortable environment even in indoor installation scenes.

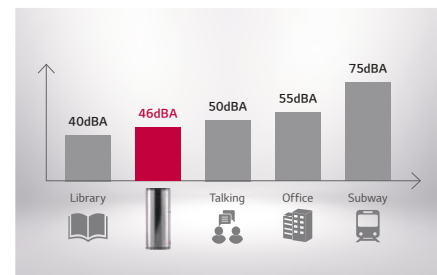

### Continuous Operation

The two heat sources, heater and heat pump, complement each other perfectly. If one of the heaters and the heat pump fails, the other heat source allows emergency operation.



## SMART CONTROL



### Embedded Wi-Fi

You can control the product through LG ThinQ app. You can check information such as current water temperature, operating mode, etc.



### Smart Diagnosis

Smart Diagnosis allows users to conveniently check setup, installation, troubleshooting and other information directly from a smartphone.



# FOR INSTALLER

## SMART CONTROL



### Easy Check & Monitoring

Easily comprehensible error messages make detecting a solution and contacting the service center simple and convenient

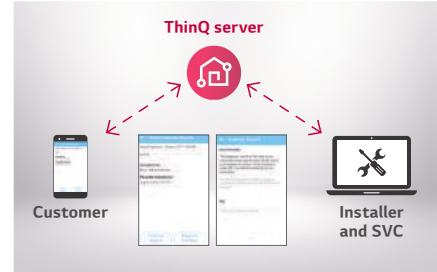

## EXTREME DURABILITY



### Dual Inverter Compressor

- Energy Saving 70% Down vs Non-Inverter
- Fast Heating 40% Up vs Non-Inverter
- Low Vibration 88% Down vs Conventional Inverter

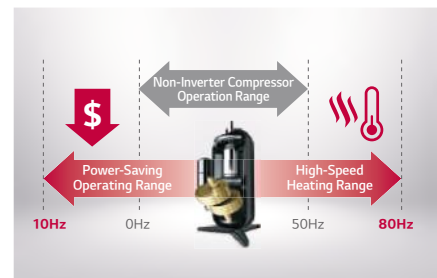

### 10-Year Warranty

10 year warranty for the core parts of the heat pump water heater - Water Tank, Compressor. TÜV Rheinland certified 10 year durability of Dual Inverter compress. Ceramic coating inside water tank meets Germany Ceramic Standard DIN 4753 and it provides 10 years of corrosion resistance.



## DESIGN



### Quick & Easy Installation

Easy to install the piping by designing the inlet and outlet piping only in one direction, You can easily connect wires in the junction box.



### Differentiated Design

LG's exclusive square design and luxury silver color make it an excellent design for the interior.

Red Dot Design Award 2020  
iF DESIGN AWARD 2020



reddot winner 2020



# LG Inverter Heat Pump Water Heater

## Product Specification & Function List

### Specification

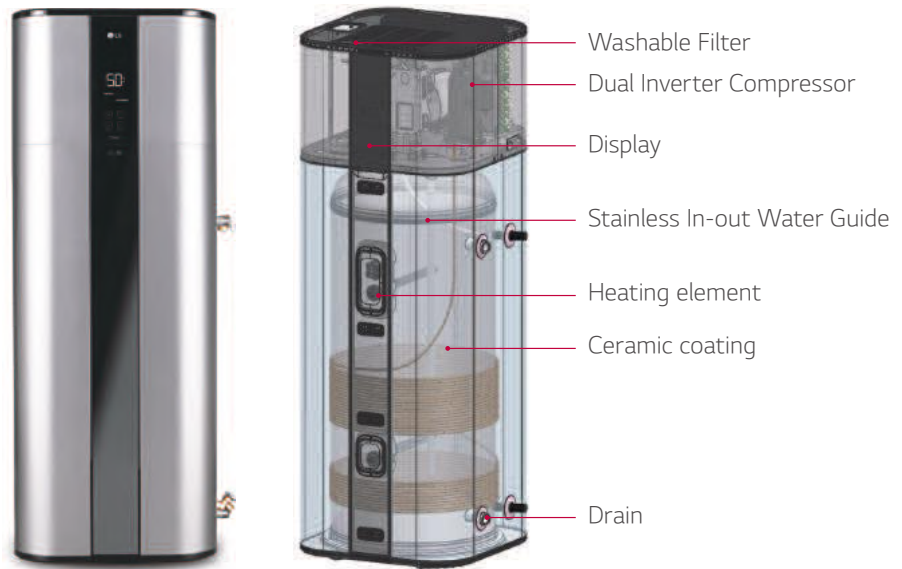

| Sales Model                     |                           |                      | Unit                | WH20S             | WH27S             |                   |
|---------------------------------|---------------------------|----------------------|---------------------|-------------------|-------------------|-------------------|
| Factory Model                   |                           |                      |                     | R5TT20F-SA1       | R5TT27F-SA0       |                   |
| Capacity                        | Volume (Normal)           |                      |                     | 200L              | 270L              |                   |
| Energy Efficiency <sup>1)</sup> | COP                       |                      |                     | 3.3               | 3.45              |                   |
| Energy Consumption              | Annual Energy Consumption |                      | kWh                 | (866)             | (715)             |                   |
| Energy Efficiency Class         |                           |                      | -                   | A+                | A+                |                   |
| Power Supply                    |                           |                      |                     | 1Φ, 230V, 50Hz    | 1Φ, 230V, 50Hz    |                   |
| Available Voltage Range         |                           |                      | V                   | (207 - 253)       | (207 - 253)       |                   |
| Indoor                          | Air Flow Rate             | H/M                  | m <sup>3</sup> /min | (6.7) / (4.4)     | (6.7) / (4.4)     |                   |
|                                 |                           | H/M                  | CFM                 | (236.6) / (155.4) | (236.6) / (155.4) |                   |
|                                 | RPM                       | H/M                  | -                   | 1,150 / 850       | 1,150 / 850       |                   |
|                                 | Sound Pressure Level      | Auto                 | dB(A)+3             | (40)              | (40)              |                   |
|                                 |                           | Turbo / Heat Pump    | dB(A)+3             | (42)              | (42)              |                   |
|                                 | Sound Power Level         |                      |                     | dB(A)             | -                 |                   |
|                                 | Dimensions                | Net (W x H x D)      | mm                  |                   | 580 x 1,625 x 582 | 580 x 2,008 x 582 |
|                                 |                           |                      | in.                 |                   | 22 3/4 x 64 x 23  | 22 3/4 x 79 x 23  |
|                                 |                           | Shipping (W x H x D) | mm                  |                   | 738 x 1,775 x 690 | 738 x 2,158 x 690 |
|                                 |                           |                      | in.                 |                   | 29 x 69 4/5 x 27  | 29 x 85 x 27 5/32 |
|                                 | Weight                    | Net                  | kg                  |                   | 100               | 115               |
|                                 |                           |                      | lb.                 |                   | 220               | 254               |
|                                 |                           | Shipping             | kg                  |                   | 118               | 133               |
|                                 |                           |                      | lb.                 |                   | 260               | 293               |
| Operation Range                 | Heating                   | °C DB                |                     | -5 - 48.9         | -5 - 48.9         |                   |
|                                 |                           | °F DB                |                     | 23 - 120          | 23 - 120          |                   |
| Max. Fuse Size                  |                           |                      | A                   | 13.5              | 13.5              |                   |
| Exterior Color Code             |                           |                      | -                   | Luxury Silver     | Luxury Silver     |                   |
| Compressor                      | Type                      |                      |                     | -                 | Twin Rotary       | Twin Rotary       |
|                                 | Motor Type                |                      |                     | -                 | BLDC              | BLDC              |
| Refrigerant                     | Type                      |                      |                     | -                 | R134a             | R134a             |
| T&P Relief Valve                |                           |                      | -                   | Yes               | Yes               |                   |
| Digital Display                 |                           |                      | -                   | Yes               | Yes               |                   |
| Wi-F i(LG ThinQ)                |                           |                      | -                   | Yes               | Yes               |                   |
| Tank Warranty                   |                           |                      | Year                | 10                | 10                |                   |

Note : 1) Water Heater Energy Efficiency (At Auto mode)

2) ThinQ Main Function

- Operation mode (Auto, Heatpump, Turbo, Vacation, Schedule), Temperature setting
- Monitoring hot water Temperature
- Maintenance point Alarm (Filter, Anode Rod, etc.)

\* Data in the bracket is to be updated.

\* Maximum heating capacity is for heating operation without any frost.

\* Some specifications may be changed without notifications due to our policy of innovation.

## Function List

| Category             | Function  | Description   |
|----------------------|---|---|
| Air Purifying        | Prefilter (Washable / Anti.Bacteria)                  | Capture dust particles over 10µm in size and finer bacteria   |
| Reliability          | Self Diagnosis  | Self-diagnostic for product protection  |
|                      | De-ice Control(Defrost)                               | In this mode, de-icing of the evaporator automatically  |
| Convenience          | HeatPump  | This mode minimizes power consumption by using only heat pump for heating.  |
|                      | Auto  | This mode provides relatively low power consumption and high recovery.<br>This mode primary uses heat pump for heating<br>This mode is factory set mode for shipping  |
|                      | Turbo   | This mode provides the highest recovery.<br>This mode uses heat pump and heating element simultaneously   |
|                      | Vacation  | This feature is recommended when the water heater is not in used for an extended period of time. In this mode, tank temperature will be maintained at about 68°F to minimize energy consumption and prevent the water heater from freezing. |
|                      | Schedule  | The Customer can set up the operation time and mode based on their Demand Condition.  |
|                      | Auto Restart Operation                                | If power is resupplied after blackout, product restart automatically  |
|                      | Two Thermistor Control <sup>1)</sup>                  | If there is a temperature difference between room temperature and desired temperature, you can use this function in other to prevent insufficient cooling and insufficient heating.   |
|                      | Overheating Protection                                | If there is a temperature difference between room temperature and desired temperature, you can use this function in other to prevent over-heating.  |
|                      | Indoor Unit Display Type                              |   |
|                      | Indoor Unit Display Light                             | Set the brightness of the display on the indoor unit  |
|                      | Anti legionella                                       | (Activates the water disinfection function, set to between 1 and 4 times per month. The water temperature reaches 60° C during a cycle.)  |
| Special Function Kit | Wi-Fi <sup>2)</sup>                                   | Easily access and control an water heater's functions from anywhere   |
|                      | Water Level Sensor Connection <sup>2)</sup>           | Detect the water level in drain pan   |
|                      | Crank Case Heater                                     | Pre.heating the compressor during winter.   |
|                      | Smart Inverter Monitoring System (SIMS) <sup>2)</sup> | Help you to easily monitor, diagnose the air conditioner and get a quick resolution. (Need to purchase SIMS Kit)  |
| Others               | Temperature Control                                   | Basic cycle control method  |

Note :

- These functions must be applied according to the model. Please refer to the following function list for each model.
- 1) : This function can be operated only when the wired remote controller is connected. The applicability of each function depends on the above table.
- 2) : Optional accessories must be purchased separately. If shown as "Embedded", this function is included in product.  
The function Wi-Fi is only compatible with 2.4 GHz band. (802.11 b/g/n)
- Some specifications may be changed without notifications due to our policy of innovation.